



Mottingham Road, London, SE9 4QZ

Guide Price £210,000 – £225,000

**COCKBURN**  
ESTATE AND LETTINGS AGENTS

Guide Price £210,000 - £225,000. Located in Mottingham Village this one bedroom flat is just a few minutes walk from Mottingham train station and is ideally situated for great travel links. Comprising one bedroom, kitchen, bathroom and reception room, there is also a balcony just off the reception room. There is private parking to the rear of the property and also a storage cupboard is included in the communal area. An excellent first time buy or investment opportunity.



## Mottingham Road, London, SE9

APPROX. GROSS INTERNAL FLOOR AREA 520 SQ FT 48.3 SQ METRES

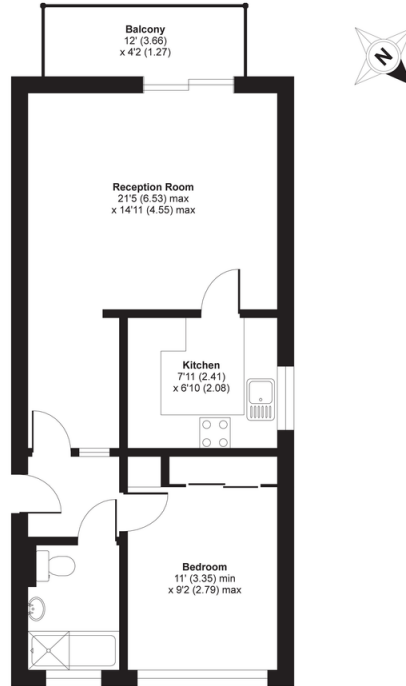

FIRST FLOOR

Whilst every attempt has been made to ensure the accuracy of the floor plan contained here, measurements of doors, windows and rooms are approximate and no responsibility is taken for any error, omission or misstatement. These plans are for representation purposes only as defined by RICS Code of Measuring Practice and should be used as such by any prospective purchaser. Specifically no guarantee is given on the total square footage of the property if quoted on this plan. Any figure given is for initial guidance only and should not be relied on as a basis of valuation.

Copyright nichecom.co.uk 2019 Produced for Cockburn REF : 515192



**Cockburn EA**  
38 Mottingham Road, Mottingham,  
London, SE9 4QR

t: 020 8857 8857  
cockburn-online.co.uk

IMPORTANT: we would like to inform prospective purchasers that these sales particulars have been prepared as a general guide only. A detailed survey has not been carried out, nor the services, appliances and fittings tested. Room sizes should not be relied upon for furnishing purposes and are approximate. If floor plans are included, they are for guidance only and illustration purposes only and may not be to scale. If there are any important matters likely to affect your decision to buy, please contact us before viewing the property.