



## Links Court, Green Lane, SE9

Rent: £1,050pcm

**COCKBURN**  
ESTATE AND LETTINGS AGENTS



**\*\*AVAILABLE IMMEDIATELY\*\* \*\*REDUCED REFERENCING FEES\*\***

Cockburn are very pleased to present this two bedroom flat, ideally located within close proximity to New Eltham Station and the various local shops and amenities. The property comprises of two bedrooms, bathroom, lounge/diner, fitted kitchen and also comes with an allocated parking space.

Call Cockburn now to arrange a viewing!

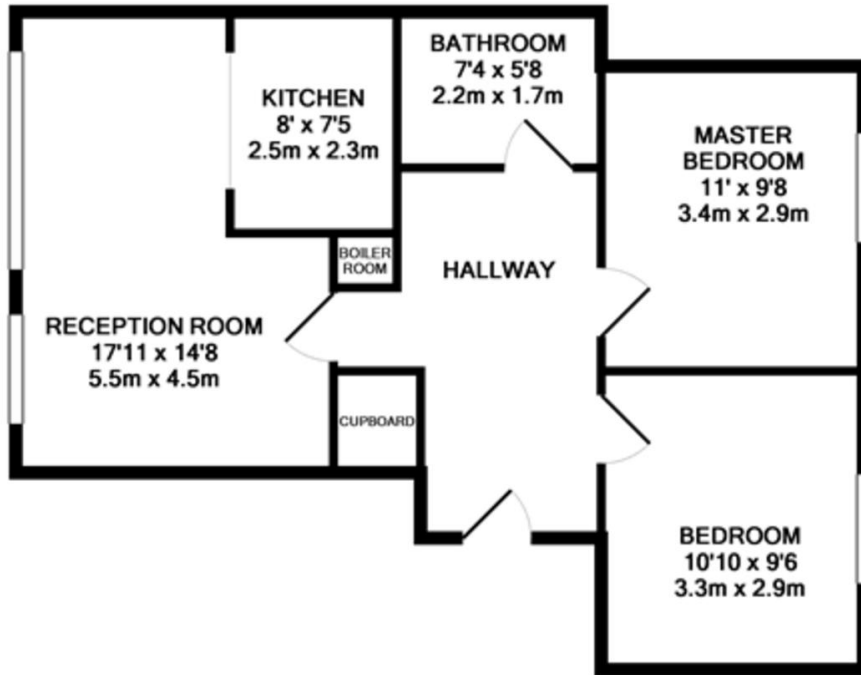

TOTAL APPROX. FLOOR AREA 575 SQ.FT. (53.4 SQ.M.)

Whilst every attempt has been made to ensure the accuracy of the floor plan contained here, measurements of doors, windows, rooms and any other items are approximate and no responsibility is taken for any error, omission, or mis-statement. This plan is for illustrative purposes only and should be used as such by any prospective purchaser. The services, systems and appliances shown have not been tested and no guarantee as to their operability or efficiency can be given

Made with Metropix ©2016

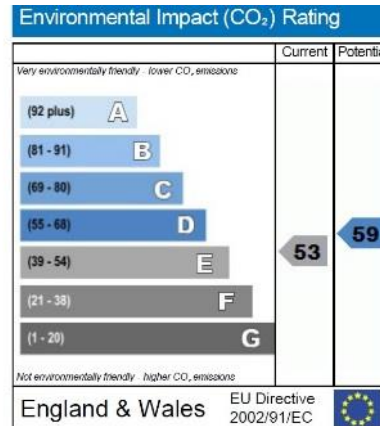
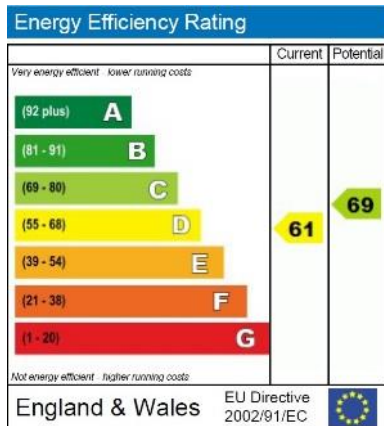

Cockburn EA  
352 Footscray Road, New Eltham, London, SE9 2EB  
t: 020 8859 8590

cockburn-online.co.uk

**COCKBURN**  
ESTATE AND LETTINGS AGENTS

IMPORTANT: we would like to inform prospective purchasers that these sales particulars have been prepared as a general guide only. A detailed survey has not been carried out, nor the services, appliances and fittings tested. Room sizes should not be relied upon for furnishing purposes and are approximate. If floor plans are included, they are for guidance only and illustration purposes only and may not be to scale. If there are any important matters likely to affect your decision to buy, please contact us before viewing the property.