



Broadway, Bexleyheath

Rent: £800pcm



Broadway, Bexleyheath

****1 BEDROOM FLAT**** This stunning first floor flat is located in the heart of Bexleyheath within walking distance of the train station. The property benefits from; 1 double bedroom, spacious lounge, modern fitted kitchen and a modern bathroom. Available now so call Cockburn immediately to arrange a viewing!

ROOM MEASUREMENTS

LOUNGE 17' 8" x 13' 1" (5.4m x 4m)

BEDROOM 16' 2" x 8' 7" (4.95m x 2.62m)

KITCHEN 12' 7" x 5' 10" (3.84m x 1.8m)

BATHROOM 8' 0" x 4' 11" (2.44m x 1.52m)

IMPORTANT NOTE Please note that all measurements are approximate. We strongly recommend that all the information which we provide is verified by yourself on inspection.

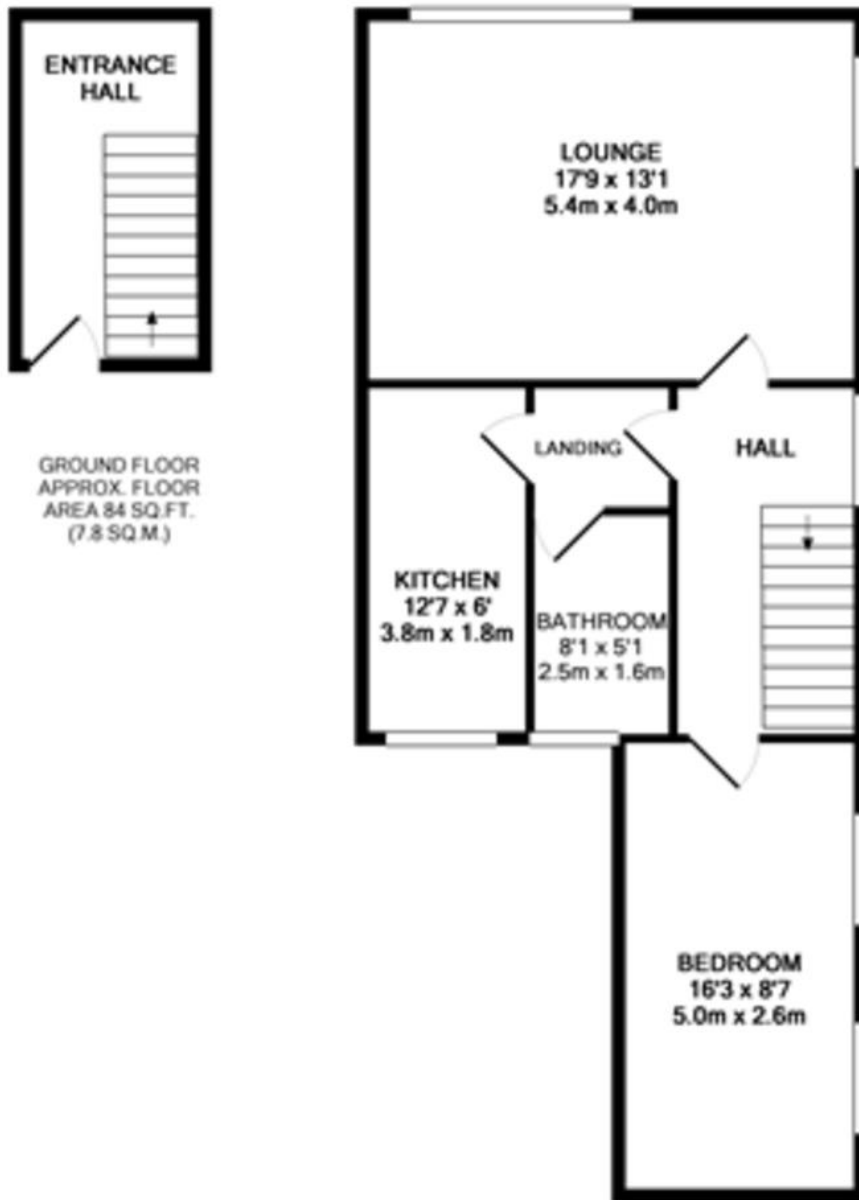

Energy Efficiency Rating

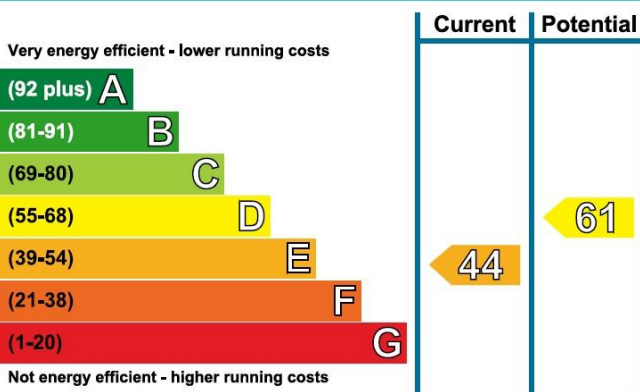

The graph shows the current energy efficiency of your home.

The higher the rating the lower your fuel bills are likely to be.

The potential rating shows the effect of undertaking the recommendations on page 3.

The average energy efficiency rating for a dwelling in England and Wales is band D (rating 60).

Cockburn EA
352 Footscray Road, New Eltham, London, SE9 2EB
t: 020 8859 8590

cockburn-online.co.uk

COCKBURN
ESTATE AND LETTINGS AGENTS

IMPORTANT: we would like to inform prospective purchasers that these sales particulars have been prepared as a general guide only. A detailed survey has not been carried out, nor the services, appliances and fittings tested. Room sizes should not be relied upon for furnishing purposes and are approximate. If floor plans are included, they are for guidance only and illustration purposes only and may not be to scale. If there are any important matters likely to affect your decision to buy, please contact us before viewing the property.